

REVISIONS		REV BY	APPROVED	DATE
LTR	DESCRIPTION	THH	KPW	4/3/04
A	INITIAL RELEASE			
F	SEE ECO NS4650F	JAM		

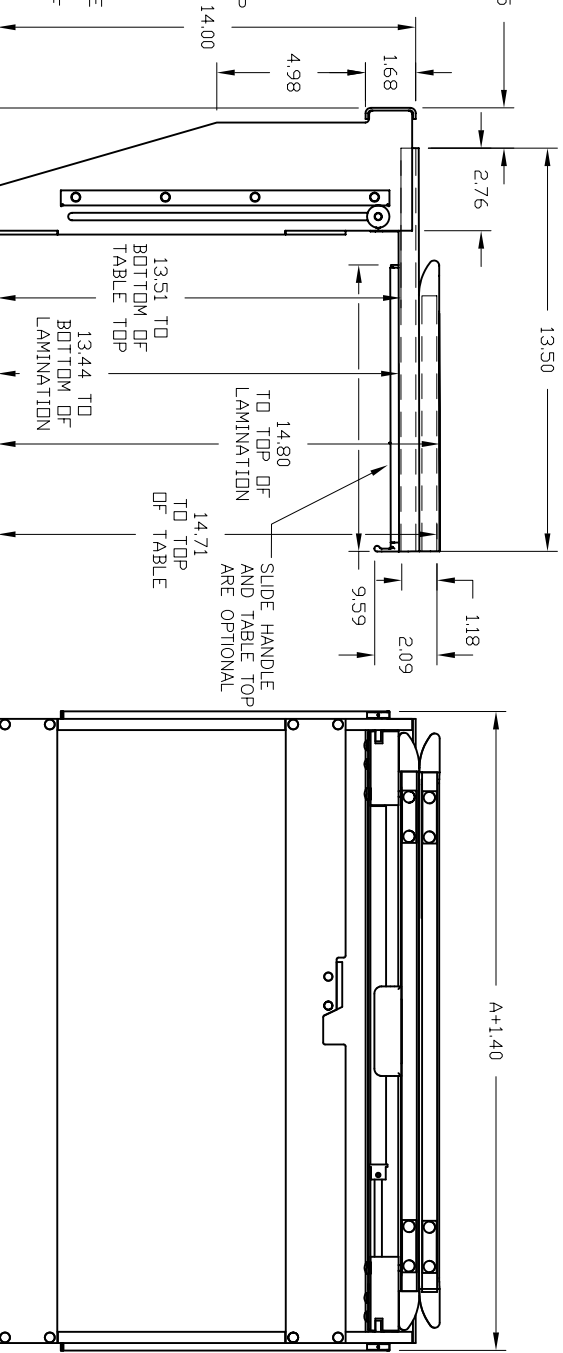
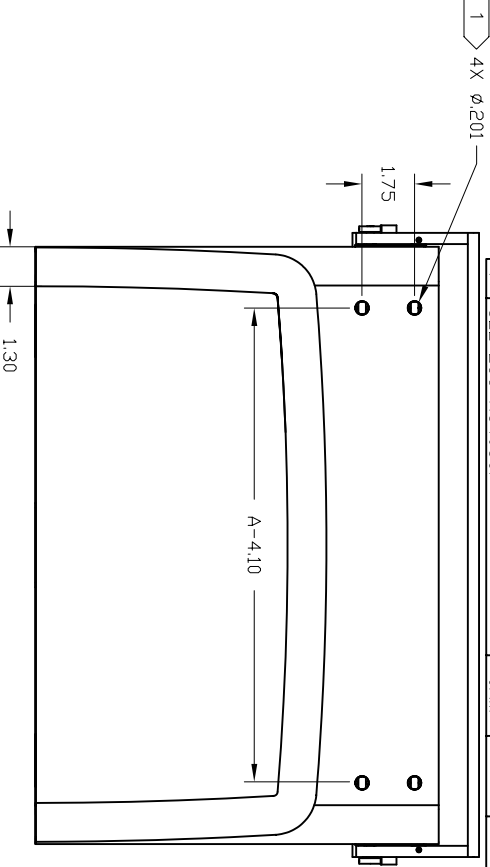
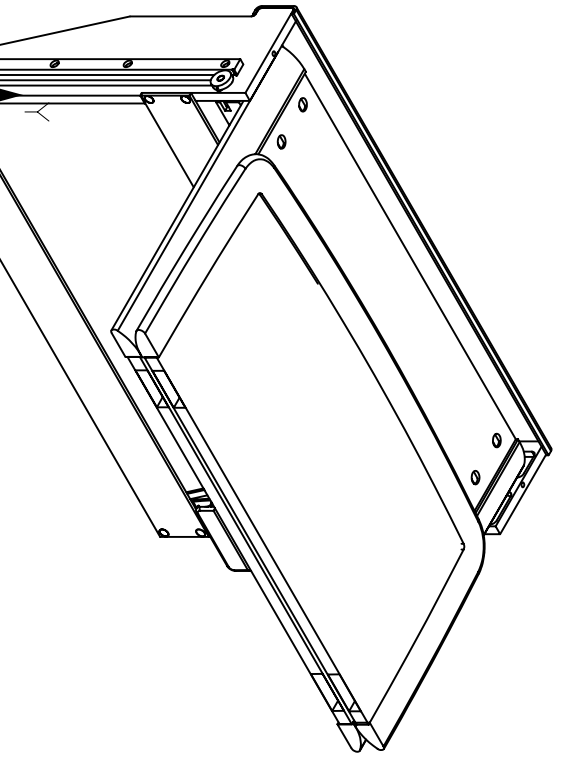

NOTES:
 TABLE TOP INFORMATION
 A) THE COMPLIANCE OF THE INSTALLATION OF THE TABLE TOP TO FEDERAL REGULATIONS IS THE RESPONSIBILITY OF THE INSTALLER.
 B) THE SIZE AND LOCATION OF THE TABLE TOP MOUNTING HOLES ARE AS INDICATED.

AIRCRAFT ATTACHMENT INFORMATION
 A) STRUCTURAL SUBSTANTIATION OF THE AIRCRAFT STRUCTURE IS THE RESPONSIBILITY OF THE INSTALLER.
 B) FASTENERS MUST NOT INTERFERE WITH THE OPERATION OF THE MECHANISM.
 C) COMPLIANCE TO APPLICABLE FEDERAL AVIATION REGULATIONS REGARDING ASLE CLEARANCE REQUIREMENTS IS THE RESPONSIBILITY OF THE INSTALLER.

MECHANICAL INFORMATION WITHOUT TABLE TOP
 A) WEIGHT OF THE MECHANISM - 5.13 LBS FOR A - 19 TABLE (±.10 LB PER INCH)
 B) THE LOCATION OF THE CENTER OF GRAVITY IN THE STOWED POSITION IS AT X=-1.13, Y=6.01. THE CENTER OF GRAVITY IN THE DEPLOYED POSITION IS LOCATED AT X=-1.30, Y=9.80. Z IS APPROX AT THE GEOMETRIC CENTER.
 C) THE MECHANISM CAN SUPPORT AN ULTIMATE LOAD OF 150 LBS. APPLIED 10.85 INCHES FROM THE INBOARD FACE OF THE SIDEPLATES AND CENTERED ON THE A DIMENSION. SEE STRESS REPORT R22165. CONVERT ULTIMATE LOAD TO AN ALLOWABLE TABLE TOP WEIGHT WITH THE FOLLOWING FORMULA: (WEIGHT OF ITEMS + WEIGHT OF TABLE TOP) X ULTIMATE LOAD FACTOR MUST BE LESS THAN OR EQUAL TO 150 LBS.
 E) SEE OPERATION MANUAL M22165 FOR ADDITIONAL INFORMATION ON MECHANISM OPERATION AND MAINTENANCE.

A= DASH NUMBER (TABLE TOP WIDTH)

54650-XX IS THE TABLE MECHANISM ONLY.
 54650-XX-01 IS THE TABLE MECHANISM PLUS THE TABLE TOP WITH
 22420-02 SLIDE HANDLE WITH EPS-103-02 + -03 FINISH

INSPECTION CLASS		DRAWN		TITLE	
UNLESS OTHERWISE SPECIFIED	ANGULAR	RAB	3/29/04	INSTALLATION DRAWING	
DECIMAL XX ± .01	TOLERANCES:	FINISH:		SIZE	
XXX ± .005		NONE		A	
DIMENSIONS ARE IN INCHES		MATERIAL:		DWG NO.	
ALL MACHINED SURFACES		NONE		NS4650	
DO NOT SCALE DRAWING				CAD FILE	
				54650-XX-E-F	
				SHEET	
				1 OF 1	

The data, concepts or designs contained herein are the exclusive property of Entitec, Inc. and shall not be used, disclosed, copied, reproduced or otherwise transmitted in any form without the written consent of Entitec, Inc.